

# CONTENTS

GENERAL INFO | **2**

DISCIPLESHIP | **3**

WEEKEND WORSHIP | **4**

SERMON SERIES | **5**

SPECIAL SERVICES | **6**

ASSISTING WITH WORSHIP | **7**

SPECIAL EVENTS | **8-9**

GIVING TO OTHERS | **10-11**

BIBLE STUDIES | **12-16**

CLC PRESCHOOL | **17**

CARE | **18-19**

CHILDREN | **20-21**

FELLOWSHIP: SENIORS | **22**

FELLOWSHIP: YOUNG ADULTS | **23**

HEALTH & WELLNESS | **24**

MILITARY | **25**

MUSIC | **26-27**

OUTREACH | **28-30**

PRAYER | **31**

STUDENTS | **32-33**

WOMEN | **34-36**

STAFF DIRECTORY | **37**

CHURCH MAPS | **38-40**

## LOCATION KEY |

**C** CARMEL SITE

**F** FISHERS SITE

**D** DOWNTOWN INDY SITE

**A** ALL SITES



# GENERAL INFO

## STAY INFORMED!

**CLC CONNECT** is our online community and communication tool. Log in 24/7 from any computer, smartphone, or tablet to access the most up-to-date calendar and directory information. Use it to update your contact information and view schedules, reach out to disciples or visitors, and more. CLC Connect is also the primary way small groups and volunteer teams communicate with each other. Log in by clicking on the CLC Connect link at the top of our website ([www.CornerstoneLutheran.church](http://www.CornerstoneLutheran.church)) and get connected today! Have questions or trouble logging in? Contact Karen Minniear ([kminniear@cornerstone.lutheran.church](mailto:kminniear@cornerstone.lutheran.church), 317.814.4252 x269).

**OUR WEEKLY ENEWS** comes out mid-week. Subscribe at [www.CornerstoneLutheran.church](http://www.CornerstoneLutheran.church) by clicking on "ENEWS SIGNUP" (bottom of the page).

**SOCIAL MEDIA:** Keep up with daily news, blogs, and upcoming events at the site(s) of your choosing! Like or follow us on:

- **Facebook:**  
@CornerstoneLutheran  
@CornerstoneCarmel  
@CornerstoneFishers  
@CornerstoneDowntownIndy  
@ThePlayArea (*CLC Fishers Play Area*)
- **Instagram:** @CornerstoneLutheran
- **Twitter:** @CornerstoneLuth

## DOWNLOAD CLC APP

Check out the new CLC App, available for iPhone, iPad, Apple TV, Android, Windows Phone, and Amazon phones and tablets. Use the app to get the latest news and events, give online, live stream our worship services, look up past sermons, and more! Just go online to an app store and search "Cornerstone Lutheran Church".

## WEATHER ISSUES

Any worship service cancellations will be communicated through local media outlets and our Facebook pages. Church activities during the week will follow that site's school district closings (Carmel-Clay schools for CLC Carmel and Hamilton Southeastern schools for CLC Fishers).

# DISCIPLESHIP

## WHAT'S DISCIPLESHIP?

At Cornerstone Lutheran, you don't become a *member* of our church, you become a *disciple* of Jesus Christ at CLC—by deepening your relationship with him through worship, Bible study, and service. In this Ministry Catalog we have highlighted opportunities for you in these three areas. Grow in your faith as we take this discipleship journey together!

## DISCOVER CLC CLASSES

### **C** Sunday, Jan. 7 - Mar. 4, 9:30 am CLC Carmel, room 102

Discover Cornerstone Lutheran is an 8-week adult information class for those interested in learning more about what it means to be a disciple at CLC and partner with us in ministry. (The class after this one will be at CLC Fishers starting March 11 at 10:15 am.)

To register, contact Clarissa Hay ([chay@cornerstonelutheran.church](mailto:chay@cornerstonelutheran.church), 317.814.4252 x216).

*For your children, the nursery and all children/student education classes take place at the same time.*

## SMALL GROUPS

An important element of discipleship is establishing bonds of friendship with other Christians. CLC supports and encourages its disciples to form Small Groups for Bible study, service, and fellowship. If you are interested in starting or being part of a Small Group, contact Clarissa Hay ([chay@cornerstonelutheran.church](mailto:chay@cornerstonelutheran.church), 317.814.4252 x216). You can also fill out an online form at [www.CornerstoneLutheran.church/article/small-groups-start-here](http://www.CornerstoneLutheran.church/article/small-groups-start-here).

## GIVING

We thank you for your continued and generous giving to the ministries of CLC. For your convenience, we offer multiple ways to give.

- By using envelopes sent to you on a quarterly basis: Mail to CLC or put in an offering plate.
- Through CLC Connect: Log onto [cornerstonelutheran.ccbchurch.com](http://cornerstonelutheran.ccbchurch.com) and click on the "Give" tab
- Through CLC's new app (see. p. 2)

For information on gifting stock or giving through your IRA, contact Holly Reay ([hreay@cornerstonelutheran.church](mailto:hreay@cornerstonelutheran.church), 317.814.4252 x214). Thank you for helping to further Christ's kingdom through your first-fruits giving!

# WEEKEND WORSHIP

## C CARMEL

4850 E. Main St., Carmel IN

**SANCTUARY: Saturdays, 5 pm  
Sundays, 8 & 10:45 am**

These services follow a more traditional path. Communion is on the 1st, 3rd, and 5th weekends. (West side of building.)

**WORSHIP CENTER: Saturdays, 4:45 pm  
Sundays, 8:30 & 10:35 am**

These services are more contemporary. Communion is on the 2nd, 4th, and 5th weekends. (East side of building.)

## F FISHERS

13450 E. 116th St., Fishers IN

**Sundays, 9 & 11 am**

9 am worship time is more traditional, while 11 am worship is more contemporary. Communion is on the 1st, 3rd, and 5th Sundays of the month.

## D DOWNTOWN INDY

The Pin (325 S. College Ave., Indpls.)

**Sundays, 10 am**

This community of believers wants to see the Word of God alive in Downtown Indianapolis and help spread the Good News of Christ. Contact Victor Minetola ([vminetola@cornerstonelutheran.church](mailto:vminetola@cornerstonelutheran.church)).

## C TAIZÉ WORSHIP

**First Saturday of the month  
(Dec. 2, Jan. 6, Feb. 3), 6:15-6:45 pm  
CLC Carmel Prayer Chapel**

This brief service consists of prayer, meditation, and simple songs.

## ONLINE WORSHIP

If you ever find yourself unable to come to church, worship online with your CLC family! Services are live streamed at the following times:

### CLC CARMEL

#### Worship Center

- Saturdays, 4:45 pm
- Sundays, 8:30 & 10:35 am

#### Sanctuary

- Sundays, 10:45 am

### CLC FISHERS

- Sundays, 9 & 11 am

*Services are also available on demand at [www.CornerstoneLutheran.church/clctv](http://www.CornerstoneLutheran.church/clctv) to watch from your electronic devices. Try it on our new app! (see p. 2)*

# SERMON SERIES

## A DECEMBER

### **"Advent Encounters"**

Each weekend of Advent we will encounter a voice in Scripture calling us to put aside the frills and consumerism of the busy Advent Season and instead prepare a place in our hearts for our coming Savior.

- **Dec. 2-3:** "A Vision of the Bride"  
(Revelation 21:1-7)
- **Dec. 9-10:** "Christmas Preparations"  
(Luke 3:1-20)
- **Dec. 16-17:** "Joy in Sorrow"  
(Zephaniah 3:14-20)
- **Dec. 23-24 (Christmas Eve):**  
"Real Hope" (Luke 2:1-20)  
*(Christmas Eve service times are on p. 6.)*

## A JANUARY & FEBRUARY

### **"Revealed."**

Who is the real Jesus? That question is often posed to bait people into thinking there is something more to who Jesus is, as if someone were hiding something. In the Bible, Jesus is revealed. There is no hiding. On the contrary, when the facts are closely examined, we see Jesus in ways that are unexpected, but those ways are just as he wants to be revealed.

- **Jan. 6-7 (Epiphany):**  
"Inclusive" (Matthew 2:1-12)
- **Jan. 13-14:** "Surprising"  
(John 1:43-51)
- **Jan. 20-21:** "Magnetic" (Mark 1:14-20)
- **Jan. 27-28:** "Authoritative"  
(Mark 1:21-28)
- **Feb. 3-4:** "Secretive" (Mark 1:29-39)
- **Feb. 10-11 (Transfiguration):**  
"Unveiled" (Mark 9:2-9)

# SPECIAL SERVICES

## **C** MIDWEEK

### **F** ADVENT WORSHIP

**"Together in Advent"**

**Wednesdays, Dec. 6, 13, 20**

- Noon, Carmel Prayer Chapel
- 7 pm, Carmel Sanctuary
- 7 pm, Fishers

Our Advent Midweek Worship services will focus on different aspects of family giving and sharing rather than materialism.

## **C** FESTIVAL OF

### **F** LESSONS & CAROLS

**Dec. 9-10**

- 5 pm (Dec. 9), Carmel Sanctuary
- 8 & 10:45 am (Dec. 10), Carmel Sanctuary
- 9 am (Dec. 10), Fishers

These worship services are filled with special music and readings that foretell and celebrate the birth of Christ. Saturday's service at Carmel will be led by our Children's Music program and other youth, making it a great service for families with children to attend. Sunday's services at Carmel and Fishers will feature several instrumentalists and choirs.

## **A** CHRISTMAS EVE/DAY

### **CARMEL**

#### Worship Center

- Dec. 23 (Sat): 4:45 pm
- Dec. 24 (Sun): 10:35 am, 4 & 6 pm

#### Sanctuary

- Dec. 23 (Sat): 5 pm
- Dec. 24 (Sun): 10:45 am  
3, 5, 7, 9, 11 pm
- Dec. 25 (Mon): 10 am

### **FISHERS:**

- Dec. 24 (Sun): 10 am, 5, 7, 11:15 pm

### **DOWNTOWN INDY:**

- Dec. 24 (Sun): 10 am

*(Services on Dec. 30-31 are the usual weekend service times—no additional evening worship on Dec. 31.)*

## **C** ASH WEDNESDAY

### **F** Wednesday, Feb. 14

- Noon, Carmel Prayer Chapel
- 6:45 pm, Carmel Worship Center
- 7 pm, Carmel Sanctuary
- 7 pm, Fishers

## **C** MIDWEEK LENT

### **F** Wednesdays, Feb. 21-Mar. 21

- Noon, Carmel Prayer Chapel
- 7 pm, Carmel Sanctuary
- 7 pm, Fishers

# ASSISTING WITH WORSHIP

## A VOLUNTEERS NEEDED

As you can imagine, with nine worship services spread over three sites, the need for volunteers to keep worship services running smoothly is vital. And, it's up to ALL of us to take just a little time to help make that happen. At which site are you worshipping? How can you help before, during, or after a service?

A great part about volunteering for a worship service is that you'll already be at church, so it really doesn't take much of your time! And, you'll only be helping for certain services, not every week.

Please look at the list to the right and see where you can serve. And don't worry, you'll get brief training on what to do. These volunteer jobs are needed for all services at CLC Carmel Sanctuary & Worship Center, CLC Fishers, and CLC Downtown Indy.

- Altar Guild
- AV/Sound
- Bulletin Assembly
- Coffee/Donut Time
- Communion Assistants
- Facilities Lock-Up
- Greeters
- Musicians (*see p. 26-27*)
- Readers
- Ushers
- Welcome Desk

To be part of a specific volunteer group at your worship site, contact Karen Minniear ([kminniear@cornerstone.lutheran.church](mailto:kminniear@cornerstone.lutheran.church), 317.814.4252 x269).



# SPECIAL EVENTS @ CARMEL

## ☉ BREAKFAST WITH BABY JESUS

**Saturday, Dec. 2, 8:30 & 9:30 am**  
**CLC Carmel Gym**

This by-reservation-only event is for families with children in 2nd grade and younger (older siblings also invited). The morning starts with breakfast, followed by time for crafts. There will also be a chance for them to dress up as angels, shepherds, wise men, or animals, and gather around the manger for pictures! For more information, including space availability, go to [www.CornerstoneLutheran.church](http://www.CornerstoneLutheran.church) and search "breakfast".

## ☉ ADVENT BY CANDLELIGHT

**Tuesday, Dec. 5, 7 pm**  
**CLC Carmel Sanctuary & Gym**

Advent by Candlelight is a serene, candlelit evening of spiritual outreach and fellowship for women. The evening focuses on celebrating the wonder and grace of the birth of Jesus, and includes dessert and a program with personal stories of faith and Christmas carols. More information is available at [www.CornerstoneLutheran.church](http://www.CornerstoneLutheran.church) (search "Advent by Candlelight").

## ☉ COOKIE WALK

**"Christmas Cookies, Crafts, and More!"**  
**Saturday, Dec. 9, 9-11 am**  
**CLC Carmel Gym**

Fill a can with a wide variety of home-made Christmas cookies at our annual cookie walk. There will also be other home-baked goods and crafted gifts. Money raised goes to missions.

This very popular event (sponsored by the Lutheran Women's Missionary League) is well attended by both our church family and community, so we need your help! Please consider baking something or donating a craft or small gift. Items may be dropped off in the gym kitchen by Friday, Dec. 8.

And, just by shopping you will help different missions! Each of the following projects will receive 25% of the profits:

1. CLC efforts in Guatemala
2. CLC Military Ministry Bikes for Vets project
3. Team World Vision's Clean Water project
4. Connection Ministries (disabilities ministries).





# SPECIAL EVENTS @ FISHERS

## F LIVING NATIVITY

**Saturday, Dec. 9, 6-8 pm**  
**CLC Fishers (both inside & outside)**

Join us this evening for a retelling of the nativity story, complete with live animals, Christmas caroling, cookies, and more. Be a part of this celebration of the greatest event in the history of the world! Cost is a non-perishable food item or new toy.

Come anytime you like between 6-8 pm. Groups will head out every 20 minutes. A portion of this event will take place outside, so dress accordingly.

### **Can you give your time for this event?**

As this is an event for the community, we are in need of volunteers to make the event successful and memorable for them! Sign up to volunteer at [www.CornerstoneLutheran.church](http://www.CornerstoneLutheran.church) (search "living nativity").

## F CHRISTMAS CAROLING

**Thursday, Dec. 21, 5:30 pm**

Let's have a caroling night! We'll meet at 5:30 pm for a child-friendly dinner at CLC Fishers, then leave for caroling at 6:15 pm and be done by 7:30 pm. To reserve your spot for dinner, contact Ann Sobierajski ([anns@cornerstonelutheran.church](mailto:anns@cornerstonelutheran.church), 317.814.4252 x203).

## F DADDY-DAUGHTER DANCE

**Saturday, Feb. 17, 6-8 pm**  
**CLC Fishers**

CLC Fishers is hosting a community Daddy-Daughter Dance! Daughters from Pre-K through 12th grade are invited and may be escorted by dad, grandpa, or any other adult. Complimentary photography will be available at the dance. Keep watch for how to register. A donation of \$10/family is suggested with 100% of proceeds going to CLC Fishers MOPS.)

**Volunteers needed!** Contact Kevin and Jaime Karlander ([Jhuggen@aol.com](mailto:Jhuggen@aol.com).)

## F PURDUETTES SHOW

**Saturday, April 14, 2018, 7 pm**  
**(Dinner before at 5:30 pm)**  
**CLC Fishers Worship Center**  
**Tickets now available**

This multi-talented troupe of women provides quality entertainment with a vast repertoire of music. Tickets are \$15 for the show and are now available. Go to [www.CornerstoneLutheran.church](http://www.CornerstoneLutheran.church) (search "Purduettes"). Proceeds from the show will benefit Indianapolis Children's Choir.



# GIVING TO OTHERS

## **A** WARMTH BAG PROJECT 2017

**Sunday, Dec. 17**

**Carmel & Fishers: during education time**

**Downtown Indy: after worship**

*"Truly I tell you, whatever you did for one of the least of these brothers and sisters of mine, you did for me."*

*~ Matthew 25:40*

It is estimated that the Indianapolis homeless population, at any given time, reaches as high as 8,000 men and women. During the winter, many of these individuals are in desperate need of clothing items and blankets to keep warm.

Last year, Cornerstone Lutheran established a Student Ministry outreach effort called "Warmth Bag Project" to support the area's homeless. Families got together and prepared care packages that included several of those most needed items: A backpack filled with a full-size fleece blanket, knit hat, scarf, fleece gloves, a pair of thermal socks, toothbrush and toothpaste, and Carmex.

Last Christmas, we distributed 144 bags to those in greatest need through a partnership with Christ Church Cathedral in downtown Indianapolis. This year, we plan to pack more than 500 bags at all three sites on December 17 and distribute them to even more places! Although this service project is sponsored by High School ministry, all ages and families are working together to complete the packing.

As this is a family event, along with all of our adult Bible Studies participants, it's important for us to know approximately how many people will be attending. Please register at [www.CornerstoneLutheran.church](http://www.CornerstoneLutheran.church) (search "warmth bags").

If you would like to contribute to this project, or need more information, you may also visit the website listed above.

# GIVING TO OTHERS

## **C** GIVING TREES

**F**

**All gifts due to CLC by December 13**

Make a child's Christmas a little brighter this year by purchasing gifts for those in need. This year, CLC is helping three groups: Prison Ministry ("Angel Tree"), Shepherd Community Center, and Lutherwood Residential Treatment Facility.

As we are helping three different organizations, please follow the instructions for the one you've chosen (available at their display) in regards to returning the gifts to church or delivering the gifts to the child. Contact the following person for information on the specific organization:

- **Angel Tree:** Marie Bade (mbade5814@comcast.net, 317.626.9151)
- **Shepherd Community Center:** Karen Carlson (krncarlson@comcast.net, 317.440.3662)
- **Lutherwood:** Mary McGhiey (mcghieym89@gmail.com, 317.413.2338)

## **C** COLLEGE CARE PACKAGES

**Sunday, February 4, 10:30 am**  
**CLC Carmel, room 102**  
**(Items collected in January)**

Volunteers pack and ship goodies and devotional materials to all CLC college students. Please put donations of individually-wrapped snacks in the donation boxes during the month of January or bring your donation to the west kitchen by 9:30 am on February 4. Be sure your college student's address is on file by contacting Tina Henderson (thenderson@cornerstonelutheran.church) For more information, call Vicki Lepper (317.626.1443).

## **A** SOCKS COLLECTION

**Month of February**

The LWML will collect new and gently-used socks for The Sharing Place and seminary families in February. Donations may be placed in the collection box outside a worship area.

# SUNDAY BIBLE STUDIES

Studying God's Word together each week is essential to growing your faith. Join in any of these classes at any time! *(For your children, the nursery and all children/student education classes take place at the same time as the adult Bible studies.)*

## **F** SUNDAYS @ FISHERS

**10:15-10:55 am**

### **PASTOR'S CLASS**

*Leaders: Pastor Scott & Others  
(Worship Center)*

### **PARENTS & TWO'S**

Be a part of this learning experience for both you and your two-year-old child together. Includes developmental play time, Bible stories, learning, and practical application for parents.

*Leaders: Paula Calabrese, Annette Probst  
(Classroom C)*

### **THE ART OF MARRIAGE**

**Jan. 7-Feb. 25**

Every marriage is unique, expressed by the colorful personalities of each spouse and textured by the circumstances at play in their lives. In this class we'll weave together expert teaching, engaging stories, man-on-the-street interviews, humorous vignettes, and much more to portray the hope and beauty of God's design for marriage.

*Leaders: Bryan & Cathy Klemm  
(Classroom N—cry room)*

### **SERVING & THRIVENT ACTION TEAMS**

**Feb. 4**

*Each of you should use whatever gift you have received to serve others, as faithful stewards of God's grace in its various forms. (1 Peter 4:10).*

As Christians, we are called to serve. Find out how forming a Thrivent Action Team can help you do more with the gifts God has given you to make a positive change in your community!

*Leaders: Pastor Scott Giger, Kevin & Jaime Karlander (Worship Center)*

# SUNDAY BIBLE STUDIES

## © SUNDAYS @ CARMEL

9:30-10:20 am

### PASTORS LARGE-GROUP CLASS

*Leaders: The Pastors (Gym)*

### PARENT CONNECTIONS

**Starting Jan. 7**

Be part of a fun, relaxed atmosphere with other parents of Sunday school children as you get to know one another, participate in interactive discussion, and read and reflect on the Book of Romans together. Each week stands alone, so if you are scheduled to volunteer, have an ill child at home, or are out of town, you can join in the next week. Our first meeting (1/7) includes good eats!

*Leader: Tom Vandergrift (room 101A)*

### GOD'S WORD FOR TODAY: 1, 2, 3 JOHN

**Jan. 7-Apr. 8**

Take a close look at the concerns over things that would threaten the welfare of the church and how, as believers, we demonstrate God's light and love.

*Leader: Tom Gambrel (room 101B)*

### IN DEPTH: GENESIS

This verse-by-verse study will continue studying how God revealed himself to the people of Israel and how God reveals himself to us through scripture.

*Leader: Varies (room 123)*

### CONSIDER YOUR CALL, BROTHERS AND SISTERS!

**Jan. 7-Feb. 11**

A call to follow Christ is basic to believing and shaping one's life and work and is a divine summons through God's Word and Sacrament to follow him.

*Leader: Pastor Dennis Perryman (rm. 100)*

### WOMEN'S STUDY: SERMON ON THE MOUNT

Get a deeper understanding of the fruit and security that comes with righteousness in the life of a true believer.

*Leader: Pam Verbarg (Seniors Lounge)*

### WOMEN'S STUDY: BRIDGES

**Jan. 21**

**"Blessed are the poor in spirit..."**

We will be starting a new series in 2018 focused on the Beatitudes. Join the ever-growing number of CLC women who seek to build deeper relationships with each other as they share insights of their faith journey. Bridges meets six times a year during the Sunday school hour at the Carmel site.

*Leaders: Karen Swayze, Ann Paetz, Jill Winkelman (room 102A)*

### PARENTS & TWO'S

See p. 12 for description.

*Leader: Donna Bobb (room 130)*

# WEEKLY BIBLE STUDIES

## F FISHERS

FOR MEN

**MEN'S BIBLE STUDY (1/9 start)**  
**Tuesdays, 6:30-7:30 am & 9-10 am**

*Leader: Lyn Grandt (classroom N)*

FOR WOMEN (\*childcare available)

**SEEKING GOD IN INFERTILITY,  
MISCARRIAGE, AND ADOPTION LOSS**  
**Tuesdays, 7-8:30 pm (1/9 start)**

See p. 15 for description.

**CREATING GOD SPACE**  
**Tuesdays, 7-8:30 pm (ongoing)**

*Leader: Kate Giger (classroom P)*

**THE WISDOM OF GOD (1/3-1/31)\***  
**THE WOMEN OF EASTER (2/7 start)\***  
**Wednesdays, 9:30-11 am**

*Leaders: Johanna Hilpert & Lonna  
Kassuelke (classroom N)*

FOR MEN & WOMEN

**FINANCIAL PEACE UNIVERSITY (2/1 start)**  
**Thursdays, 6:30-9 pm**

Learn how to eliminate debt, prepare for generations to come, and become generous givers by using biblical principles. FPU will help you learn the steps to get you to where you want to be financially. Register at [www.CornerstoneLutheran.church/adult-education](http://www.CornerstoneLutheran.church/adult-education).

*Leader: Mike Knotts (classroom N)*

## C CARMEL

FOR MEN & WOMEN

**INTERNATIONAL FRIENDS BIBLE STUDY**  
**Tuesdays, 9:30-10:30 am**

This year we are reading Psalms and Matthew in our home languages and discussing them in English. Our goal is to have conversations based on what we have read to grow our knowledge of what the Bible has to say, as well as be able to talk about philosophical and religious concepts in English.

*Leader: Jan Heimann (room 100)*

**GROWING IN THE GOSPELS**  
**Tuesdays, 1-2 pm**

Text-centered study of the Gospels focused on answering individual questions. We will read a few paragraphs and then pause for comments, observations, etc. as led by the Spirit. This class is an open discussion format.

*Facilitator: Dean Derby (room 101B)*

**LIFELIGHT: ROMANS, PT. 2**  
**Wednesdays, 6:30-7:30 pm**

Martin Luther called Romans the chief part of the New Testament and its purest Gospel. Through this study we'll see the key aspects of God's mercy in Jesus Christ.

*Leaders: Don Hawes, Chuck Mihalik, &  
Jennifer Behm (Room 101B)*

# WEEKLY BIBLE STUDIES

## © CARMEL (cont.)

### FOR MEN

#### **GIFT (GUYS IN FAITH TOGETHER)**

**Wednesdays, 6:30-7:30 am (1/10 start)**

Topic: "Paul's Letter to the Corinthians"

*Leader: Pastor Max Murphy (room 102)*

#### **BIBLES & BAGELS**

**2nd & 4th Saturdays, 7:30-9 am,  
(ongoing) room 101B**

*Topic & Leader varies*

### FOR WOMEN (\*childcare available)

#### **LIFT: 1<sup>ST</sup> CORINTHIANS (1/9 start)\***

**Tuesdays, 9:15-10:30 am**

Paul's letter to the Corinthians addresses issues of their day, many of which still plague us today.

*Leader: Pastor Max Murphy (room 102)*

#### **THE PROMISED ONE (1/10 start)\***

**Wednesdays, 9:15-11:15 am**

See how the Old Testament points us to the person of Christ.

*Leaders: Michelle Oakley & Marcey Zolner (room 100)*

#### **SEEKING GOD IN INFERTILITY, MISCARRIAGE, AND ADOPTION LOSS Tuesdays, 7-8:30 pm (1/9 start)**

This support group for women and couples meets every other week at various locations. Contact Katie for meeting spot ([katiebrunette12@gmail.com](mailto:katiebrunette12@gmail.com)).

*Leaders: Katie Brunette & Dani Reher  
(location varies)*

#### **THE BROKEN WAY (1/10 start)\***

**Wednesdays, 4:30-6 pm**

The broken way beckons you into more time, more meaning and more authentic relationships to gain intimacy with God.

*Leader: Karla Ralls (room 101A)*

#### **ROMANS, PART 3 (PRECEPTS STUDY)\***

- **Wednesdays, 6:30-7:30 am (1/3 start)  
(Precepts In & Out)**

*Leader: Jan Williams (room 101A)*

- **Thursdays, 9:15-11 am (1/4 start)**

*Leader: Jan Williams (room 101A)*

This study is a continuation, but you don't have to have attended to participate now. New participants are always welcome.

#### **KNOWING GOD BY NAME (2/15 start)**

**Thursdays, 7-8:30 pm**

Learn about the 35 Hebrew names of God the describe his character, relationships, and purpose.

*Leaders: Christine Mayes & Chris Doron  
(room 101A)*

Register for any CLC women's Bible study  
at [www.cornerstonelutheran.church/  
womens-bible-studies](http://www.cornerstonelutheran.church/womens-bible-studies)

# WEEKLY BIBLE STUDIES

## D DOWNTOWN INDY

FOR MEN

**1ST CORINTHIANS (1/9 start)**

**Tuesdays, 12-1 pm**

**Emmis Building (40 Monument Circle)**

*Leader: Pastor Max Murphy*

FOR WOMEN

**THE WISDOM OF GOD (1/9-2/13)**

**Tuesdays, 11:30 am-12:30 pm**

**Pearings Cafe (6 W. Washington St.)**

This study will explore the books of Proverbs, Ecclesiastes, and Song of Solomon. New participants are always welcome.

*Leader: Jan Williams*

FOR MEN & WOMEN

**JOINING JESUS ON HIS MISSION**

**Wednesdays, 7 pm**

See your life as a 21st century disciple of Jesus as you respond to the everyday opportunities Jesus places in your path. Contact Victor Minetola ([vminetola@cornerstonelutheran.church](mailto:vminetola@cornerstonelutheran.church)) for location of study.

*Leader: Vicar Victor Minetola*

## STUDY RESOURCE: RIGHTNOW MEDIA

Disciples and friends at Cornerstone Lutheran have access to an extensive, online video library! Let RightNow Media be a resource for your family, small group, co-workers, neighbors, anyone you know! Wherever you have Internet access, you have a plethora of Bible studies and quality Christian programming for children available to you! Studies recommended by disciples at CLC can be found via the "Cornerstone Lutheran Church" link on our RightNow media page.

Get set up with a free account and share this gift with others by visiting [www.RightNow.org/Account/Invite/cornerstonelutheran](http://www.RightNow.org/Account/Invite/cornerstonelutheran). Need help? Contact Clarissa Hay ([chay@cornerstonelutheran.church](mailto:chay@cornerstonelutheran.church), 317.814.4252 x216).



# CLC PRESCHOOL

## ◎ WHO WE ARE

Cornerstone Lutheran Preschool is a ministry of Cornerstone Lutheran Church, designed to serve children ages 2 through 5. An exciting blend of developmental, academic, and spiritual teaching in a Christian setting, our preschool has been reaching out to children and their families since 1985.

At Cornerstone Lutheran Preschool we offer a safe, nurturing, Christ-centered environment with small class sizes. We partner with parents in teaching Jesus' love for each child and preparing them for future school experiences by providing a positive atmosphere for academic, social, emotional, and physical growth.

For more information on classes, or to schedule a tour of the school, contact Teresa Millwood, Preschool Director ([tmillwood@cornerstonelutheran.church](mailto:tmillwood@cornerstonelutheran.church), 317.814.4262). Or, visit [www.CornerstoneLutheran.church/preschool](http://www.CornerstoneLutheran.church/preschool).

## REGISTRATION FOR 2018-19

The registration schedule for the 2018-19 school year is:

### **Jan. 9:**

For current preschool families.

### **Jan. 15:**

For CLC families not currently enrolled in preschool, and previous preschool families.

### **Jan. 18 and after:**

Open to the community.

To register your child, go to [www.CornerstoneLutheran.church/preschool](http://www.CornerstoneLutheran.church/preschool).

## COUNSELING SERVICES

### **C** DR. RANDY SCHROEDER

Dr. Randy offers counseling services at CLC. He holds a Ph.D. in marriage and family therapy, a master of divinity degree, and a master of education administration degree. He had a busy private counseling practice for more than 25 years, and was a professor and vice-president at Concordia Theological Seminary. To schedule an appointment or for more information, visit [DrRandallSchroeder.com](http://DrRandallSchroeder.com).

### **C** CROSS CONNECTIONS

This pastor-referred counseling service is available on site at CLC Carmel, Tuesdays through Thursdays. Each counselor holds a master's degree in the counseling field and a commitment to understanding how to apply God's Word to the brokenness of the human condition. For more information, visit [crossconnectionsounseling.com](http://crossconnectionsounseling.com).

### **PEACE COUNSELING GROUP**

Nancy Eisenman & Kristen Swart see clients by appointment at 9650 Commerce Drive, Suite 413, Carmel. Visit [peacecounselinggroup.com](http://peacecounselinggroup.com) or call 317.605.7015.

## CANCER SUPPORT

### **CANCER COMPANIONS**

Cancer Companions are trained volunteers who reach out to anyone in treatment, post treatment, or their loved ones and bring hope to the recipient's cancer journey through Christ-centered cancer support groups, one-to-one meetings, uplifting Christian cancer blogs, and "Seeing God In Your Cancer Journey"—a scripture-filled Bible study and video series. For information on helping with or being helped by Cancer Companions, contact Julia Kattner ([kattgirl@indy.rr.com](mailto:kattgirl@indy.rr.com), 317.580.0282).

### **BREAST CANCER SUPPORT GROUP**

This ministry provides support to women (disciples at CLC and others) who are dealing with breast cancer. Because of the experiences of those in the group, they are able to provide a nurturing environment for a woman to express her feelings, ask questions, and learn how to spiritually cope. The group meets whenever a newly diagnosed woman needs support. Contact Sharon Reed ([sharon-mr@sbcglobal.net](mailto:sharon-mr@sbcglobal.net), 317.842.4737).

# CARE

## ☉ CAREGIVERS SUPPORT GROUP

**Third Tuesday of the month  
(Dec. 19, Jan. 16, Feb. 20), 7-9 pm  
Seniors Lounge**

If you're caring for or making care decisions for loved ones facing health issues associated principally with aging or memory loss, find support, encouragement, and resources through our Caregivers Support Group. For more information, contact Chris Doron ([cjdoron@trafficsignalcompany.com](mailto:cjdoron@trafficsignalcompany.com), 317.339.6808).

## ☉ EMPLOYMENT MENTORING CLUB

**Second Wednesday of the month  
Room 101A**

- **Dec. 13, 7:45 pm (due to Advent)**
- **Jan. 10, 7 pm**
- **Feb. 14, 7:45 pm (due to Ash Wed.)**

If you're under- or unemployed, come to an Employment Mentoring Club's monthly meeting for one-on-one support. Mentors review cover letters and resumes, practice interviewing skills, and facilitate networking. Contact Fred Prine ([fprine@westfieldsteel.com](mailto:fprine@westfieldsteel.com), 317.409.3885) with questions.

## ☉ GRIEFSHARE

**Mondays (Jan. 22-Apr. 16), 7-9 pm  
Room 101A**

GriefShare is a recovery support group for those who have recently experienced the death of a loved one. This 13-week class can help you move toward rebuilding your life. For more information or to sign up for this class series, email Kristy Long ([kristy@indy.rr.com](mailto:kristy@indy.rr.com)).

## ☉ DIVORCECARE & DIVORCECARE FOR KIDS (DC4K)

**Mondays, Jan. 8-Apr. 2, 6-7:30 pm  
Rooms 218 & 213**

Are you hurting from separation or divorce? Find help and healing through DivorceCare and DivorceCare for Kids. There are separate classes for adults, teens, and children.

- To sign up for this class series, visit [www.CornerstoneLutheran.church/divorcecare](http://www.CornerstoneLutheran.church/divorcecare).
- For more information, contact Bob Stanton ([stanton400@gmail.com](mailto:stanton400@gmail.com)).
- To find other classes/locations in the area, visit [divorcecare.org](http://divorcecare.org).

# CHILDREN

## CORNERSTONE KIDS

(3 years old to early elementary)

- C** CLC Carmel: Sundays, 9:30-10:25 am  
Upstairs & downstairs classrooms
- F** CLC Fishers: Sundays, 10:15-10:55 am  
Education Wing

At Cornerstone Kids, we have a great time getting to know Jesus! This educational experience delivers solid biblical learning through extraordinary creativity and fun.

For more information:

- **Online:** [www.CornerstoneLutheran.church/kids](http://www.CornerstoneLutheran.church/kids).
- **Carmel:** Contact Lisa Mohler (lmohler@cornerstonelutheran.church, 317.814.4252 x215).
- **Fishers:** Contact Melissa Luepke (mluepke@cornerstonelutheran.church, 317.814.4252 x202).

## PARENTS & 2'S

- C** CLC Carmel: Sundays, 9:30-10:25 am  
Room 130
- F** CLC Fishers: Sundays, 10:15-10:55 am  
Classroom C

See more information on p. 12.

## NURSERY

(birth-3 yrs)

- C** CLC Carmel:
  - Saturdays, 4:45-6 p.m.
  - Sundays, 8 a.m.-12 p.m.  
(and different times throughout the week)
- F** CLC Fishers:
  - Sundays, 8:45 a.m.-12 p.m.

Our nursery is not just a place where you drop off your child to play, it's a place where we love and nurture your child. We offer a time of Bible learning and song time called Play-n-Worship. This nursery lesson time introduces children to God and his love for us—through music, play, and easy lessons.

Security is of the utmost importance here. Upon arrival, parents sign in their child, place a label on the child's back, and get a pager that corresponds with the number on the child's label. This pager acts as a "claim ticket" when parents return to the nursery, and only parents with these pagers can pick up their child. Our nursery, operated by church staff and volunteers who have completed background checks, have the gift to nurture God's littlest ones.

To find out more about CLC's nursery ministry, visit [www.CornerstoneLutheran.church/clcnursery](http://www.CornerstoneLutheran.church/clcnursery).

# CHILDREN

## F INDOOR PLAY AREA

**Mon.-Fri.: 9 am-1 pm & 4-7 pm**  
**Saturdays: Closed**  
**Sundays: 12-3 pm**

The Indoor Play Area at CLC Fishers is a fun two-story space for children birth through 12 years old, with a special toddler area just for those little ones age 3 and under. We ask that children wear socks and be accompanied at all times by an adult 18 years of age or older.

Stay up-to-date on wait times and closings, especially during the holidays and inclement weather, by liking our Facebook page: [facebook.com/theplayarea](https://www.facebook.com/theplayarea).

## F FRIDAY STORY TIME

**Fridays, 10-10:30 am**  
**Education Wing**

This once-a-week story time at CLC Fishers is for young children and their caregivers. We'll share a Bible lesson, music, crafts, and free play with the children visiting the Indoor Play Area during that time.

## SCOUTING

### CUB SCOUTS

For boys in Kindergarten-5th grade.

### C Carmel: Pack 188

- **Tuesday, Dec. 12, 7-8 pm**  
Pack meeting, CLC Carmel Gym
- **Friday, Jan. 26, 5-9 pm**  
Pinewood Derby, Cherry Tree Elem.
- **Sunday, Feb. 25, 1-3 pm**  
Blue & Gold, CLC Carmel Gym

Contact Marcus Holcomb  
([holky5@gmail.com](mailto:holky5@gmail.com), 317.379.2870).

### F Fishers: Pack 140

- **Monday, Dec. 18, 6:50-8 pm**  
Pack meeting
- **Monday, Jan. 29, 6:50-8 pm**  
Pack meeting
- **Friday, Feb. 9, 5-6:30 pm**  
Pinewood Derby Weigh-in
- **Saturday, Feb. 10, 10 am-12 pm**  
Pinewood Derby Race
- **Monday, Feb. 26, 5-8:30 pm**  
Pack meeting

Contact Jimmie O'Connor  
(317.750.0978).

### C AMERICAN HERITAGE GIRLS Second & Fourth Tuesdays (Dec. 12; Jan. 9, 23; Feb. 13, 27) 6-7:30 pm, room 101A

For girls in Kindergarten-12th grade.  
Contact Brenda Himler ([rbhimler@sbcglobal.net](mailto:rbhimler@sbcglobal.net), 317.566.0250).



# FELLOWSHIP: SENIORS

## © MONTHLY LUNCHES

**First Monday of the month  
(Dec. 4, Jan. 8, Feb. 5), 12-2 pm**

Senior adults are invited to a pitch-in buffet lunch the first Monday of every month. While having lunch and fellowship in room 102, they'll hear about church news and enjoy a special program. Come for an afternoon of food, fellowship, and learning. For more information, contact Bates McIndoe ([batesandjudy@yahoo.com](mailto:batesandjudy@yahoo.com), 317.571.0877).

### Upcoming topics:

- **Dec. 4:** We'll hear Christmas Carols sung by the Cornerstone Preschool children, then some CL Cstaff will lead us in singing Christmas songs.
- **Jan. 8:** Pastor Luther will give us a presentation on his recent trip to Germany and France, sharing pictures and stories of touring the cities important in the Reformation and visiting the Normandy D-Day beaches of WWII.
- **Feb. 5:** Kathy Woods of Ageless Grace Indiana will present a "Fitness Program for Body and Brain Health" which will feature anti-aging and well-being techniques while sitting and listening to music.

## © SENIORS EXERCISE

**Saturdays, 10-11 am, Gym**

This class is for men and women age 65 and older. The class focuses on maintaining and increasing flexibility, balance, and coordination through light stretching and strength building.

## © EUCHRE GROUP

**Second Wednesday of the month  
(Dec. 13, Jan. 10, Feb. 14), 1 pm  
Senior's Lounge**

Want to play with the Senior Adults' Euchre Group? Contact Fred & Phyllis Mesenbrink ([phymesen@yahoo.com](mailto:phymesen@yahoo.com), 317.770.8572).

# FELLOWSHIP: YOUNG ADULTS

All young couples and singles in their 20s and 30s are invited to meet up for Bible study, dinner, fellowship, and service as we seek to grow in our walk with Christ and each other.

## **FRIENDSMAS!**

**Wednesday, Dec. 20, 7 pm**

Come join us for cookie decorating, white elephant gifts, and some Christmas spirit! Bring a white elephant gift and a Christmas dessert and wear your best ugly sweater or sweatshirt. We will meet at Wes Smith's house—RSVP to him ([wesley.smith@betasigmapsi.org](mailto:wesley.smith@betasigmapsi.org), 260.452.6049).

## **© SUNDAYS AT NOON BIBLE STUDY** **First & Third Sundays of the Month** **(Jan. 7, 21; Feb. 4, 18), 12-1:30 pm** **Room 102**

Plan for an afternoon of food, fellowship, and an interactive Bible Study on topics of interest as we dig into the Word together.

**Jan. 7:** Kickoff—lunch provided

**Jan. 21:** Brown bag lunch

**Feb. 4:** Potluck

**Feb. 18:** Pizza

## **FISHBOWL THEOLOGY & DINNER**

**Jan. 16 & Feb. 7, 7-8:30 pm**

Meet up for dinner one evening a month for a time of fellowship. When available, one of our pastors will join in for both fellowship and great questions of theology!

**Jan. 16:** Upland Brewing

**Feb. 7:** The Lit Moose

## **SERVICE & FELLOWSHIP EVENTS**

**Jan. 27 & Feb. 24**

Each month the young adults get together for a time focused on fellowship and/or service. Through fun activities we get to know one another a bit more, forming encouraging and supportive relationships as we enjoy one another and serve others.

**Jan. 27:** Service Event

**Feb. 24:** Weekend Fellowship Event

*For more information on all these activities, follow CLC's Young Adult Ministry on Facebook – Cornerstone Lutheran Young Adult Ministry (CLCYAM) and Instagram @clcyam.*



# HEALTH & WELLNESS

## © BIKING/SPINNING

**Saturdays, Jan. 6-Mar. 24, Gym**  
**7:30 am – set up/warm up**  
**7:45-8:45 am – workout**

Bring your own bike and bike trainer, if you have one. (We will have a few extra trainers if you don't.) We will do a variety of bike workouts. Any ability level can participate! Contact Patti Vollmer (pvollm@aol.com, 317.507.1155).

## © CARDIO SCULPT

**Wednesdays, 9:15-10 am, Gym**

Increase your heart rate, build strength, move your body and meet friends! NASM Certified Personal Trainer, Hollie Nicholson, will lead you in a workout that will leave you feeling great. Drop your children off in the nursery and meet in the gym for this FREE 45-minute workout. Questions? Contact Hollie (hollie.r.nicholson@gmail.com, 317.292.4252).

## © SENIOR FITNESS

**Saturdays, 10 am, Gym**

This class is for men and women age 65 and older who currently do little or no exercise. The class focuses on maintaining and increasing flexibility, balance, and coordination.

## © MEN'S BASKETBALL

**Mondays, 7-9 pm, Gym**  
**Wednesdays, 8:30-10:30 pm, Gym**

Friendly basketball competition in an open gym format where everyone plays.

- **Mondays:** Contact Travis Birge (tbirge03@aim.com, 765.336.1261).
- **Wednesdays:** Contact Kevin Ogawa (kiyoshi12@att.net, 317.585.9210).

## © CO-ED VOLLEYBALL

**Thursdays, 7-9 pm, Gym**

Join with other players for fun, fellowship, and physical exercise. Contact Michael Minniear (mjminniear94@gmail.com, 317.460.2629).





# MILITARY

## HONORING OUR VETS & ENLISTED

We want to honor our congregation's veterans and enlisted military personnel by praying for them and honoring them throughout the year, but need your help. If you are a disciple at CLC and are a veteran or currently enlisted, or know someone from our church who is, please let us know. Contact Lindsey Thompson ([lthompson@cornerstone.lutheran.church](mailto:lthompson@cornerstone.lutheran.church)) for more information, or to update us on military personnel.

## CHRISTMAS IN JULY

We're not collecting items for our "Christmas in July" project (care packages for the troops) just yet—that's in June. But, as your shopping throughout the year, keep an eye out for deals on items like Chapstick/lip balm, travel sizes of Gold Bond powder, sunscreen, beef jerky, gum, and power/granola bars.

## WE NEED YOU!

We're looking for more people to join our team so we can take on additional projects throughout the year. If you'd like to be a part of the Military Ministry Team, please contact Lindsey (information to left).

## STAY CONNECTED

Want to keep up with the latest news and happenings with CLC Military Ministry? Join their Facebook group! Go to [Facebook.com](https://www.facebook.com), search "Cornerstone Lutheran Military", and request to join.



# MUSIC @ CARMEL

## SANCTUARY MUSIC

Join one of our music ensembles anytime! Contact Barry Bobb ([bbobb@cornerstonelutheran.church](mailto:bbobb@cornerstonelutheran.church)) or the director listed.

### CELEBRATION RINGERS

**Wednesdays, 6:15-7:15 pm, Balcony**

*Jean Darling, director*

([jean@dingalingdarling.us](mailto:jean@dingalingdarling.us), 317.509.2304)

### SANCTUARY CHOIR

**Wednesdays, 7:30-9 pm, Choir Room**

*Barry Bobb, director*

### CLC BRASS

**Thursdays, 7:30-8:30 pm, Choir Room**

*Rhod Fitzpatrick, director*

([rhodf@sbcglobal.net](mailto:rhodf@sbcglobal.net), 317.727.2838)

### CHAPEL WINDS

*Kathy Williams, director*

([kwmsindy@hotmail.com](mailto:kwmsindy@hotmail.com), 317.845.7475)

## CHILDREN'S MUSICALS

**Wednesdays, 4:30-6 pm (1/10 start)**

**Primary Praise performance: Feb. 25**

**Christus Choir performance: Mar. 11**

Our Primary Praise (K-2nd grade) and Christus Choir (3rd-6th grade) will each present their own musical! Questions? Contact Jennifer Midkiff ([jmidkiff@cornerstonelutheran.church](mailto:jmidkiff@cornerstonelutheran.church)) or Lauren Southard ([laurensouthard@me.com](mailto:laurensouthard@me.com)).

## FINE ARTS ACADEMY

**Registration opens Feb. 1**

**"Come to the Waters", June 18-22**

The Fine Arts Academy is a week-long summer arts camp for children completing Kindergarten through 8th grade. Not on our mailing list from attending previously? Email your information to Katie Schafer ([katieme\\_01@yahoo.com](mailto:katieme_01@yahoo.com)). Register at [www.CornerstoneLutheran.church/faa](http://www.CornerstoneLutheran.church/faa).

## WORSHIP CENTER

Contemporary music (in the Worship Center) is led by Pastor Max Murphy and the Worship Band. For information about being a part of our contemporary music ministry contact Pastor Max ([mmurphy@cornerstonelutheran.church](mailto:mmurphy@cornerstonelutheran.church), 317.814.4252 x225).

## MAKE A JOYFUL NOISE CHOIR

**Third Wednesday of the month (Dec. 20, Jan. 17, Feb. 21), 11:30 am Choir Room**

This women's choir meets for a short rehearsal, then travels to a local nursing home to sing. For more information, call Drevvi Lowry (317.776.2201).

# MUSIC @ FISHERS

## SANCTUARY CHOIR

**Thursdays, 7-8:30 pm**  
**Fishers Worship Center**

Our Sanctuary Choir sings twice a month at the 9 am worship service and always welcomes new singers!

*Josh Pedde, Director of Sanctuary Music* ([jpedde@cornerstonelutheran.church](mailto:jpedde@cornerstonelutheran.church))

## CHILDREN'S CHOIR

**Thursdays, 6-7 pm**

Fishers Children's Choir is for children in Kindergarten through 5th grade. They sing at various worship services.

*Josh Pedde & Bess Sullivan, directors* ([jpedde@cornerstonelutheran.church](mailto:jpedde@cornerstonelutheran.church))

## INSTRUMENTALISTS

We are always in need of individual instrumentalists to play at the 9 am traditional service.

In addition, we are looking to start a brass group (trumpets, trombones, horns, tubas). If interested, contact Dan.

*Dan Calabrese, Organist* ([dcalabrese@cornerstonelutheran.church](mailto:dcalabrese@cornerstonelutheran.church))

## WORSHIP BAND

Our worship band plays at the 11 am worship service. Band members play on a rotational basis. New singers and musicians are always welcome!

*Andrew Osborne, Dir. of Worship Arts* ([aosborne@cornerstonelutheran.church](mailto:aosborne@cornerstonelutheran.church))

# OUTREACH

## MISSION TRIP: HOUSTON

Help those affected by Hurricane Harvey by assisting in the rehab of a neighborhood (working with Gloria Dei Lutheran in Houston). The trip is being planned for sometime between mid-January and early February. If you are interested, contact Kelly Howe ([kelly\\_willing@yahoo.com](mailto:kelly_willing@yahoo.com)).

## MISSION TRIP: ALASKA

### **C** Info Meeting: Monday, Jan. 15, 7 pm

We have tentatively scheduled a mission trip to Alaska for July 28 through August 8. We will be working in Copper Center with missionary Todd Roeske, as well as doing some touring. If you are interested, be sure to come to the information meeting. Contact Eric Nelson ([enelson@cornerstonelutheran.church](mailto:enelson@cornerstonelutheran.church)) or Dave Reed ([davidcsa@aol.com](mailto:davidcsa@aol.com)).

### **A** COLLECTIONS

**Dec:** Toys for various organizations  
**Jan:** Snacks, etc. (college care packages)  
**Feb:** Socks for men, women, children

For more information on these collections, turn to p. 11. Donations can be put in the wooden boxes outside a worship areas.

### **C** DISABILITIES MINISTRY

#### FRIENDSHIP TUESDAY

**Tuesdays, 7-8:30 pm**  
**(no class 12/26, 1/2), room 102**  
Contact: Marcy Culter ([rculter@indy.rr.com](mailto:rculter@indy.rr.com), 317.843.1879).

#### FRIENDSHIP SATURDAY

**Saturdays, 9 am-3 pm, room 123**  
Contact: Carole Halcomb ([thalcomb@indy.rr.com](mailto:thalcomb@indy.rr.com), 317.446.6925).

These gatherings serve adults with intellectual disabilities through activities like singing, sharing Jesus stories, crafts, and more. Help someone with a disability learn more about the God who loves them just the way they are! (Volunteers can be adults or teens.)

### **F** SERVING & THRIVENT ACTION TEAMS

**Sunday, Feb. 4, 10:15 am**

Are you a Thrivent Financial Member? Did you know you have \$500 a year available you can use to take action and make a difference in your church and community? Find out how at this one-time session. It is easier that you think!

# OUTREACH

## © INTERNATIONAL FRIENDS

International Friends cares for our ex-pat and immigrant communities with friendship, field trips, food, and fun to help make Indiana feel more like home. CLC provides the facilities and child-care. Volunteers provide leadership. Our English classes are self-funded with an annual flat rate for student tuition that pays for books and materials required to conduct our classes.

Join as a Friend or join as a volunteer:

- Text or call Carolyn Willard:  
**317.703.0417**
- Email: [indyintlfriends@gmail.com](mailto:indyintlfriends@gmail.com)
- Check out our webpages for more information: [indyinternationalfriends.blogspot.com](http://indyinternationalfriends.blogspot.com)

### **INTERNATIONAL BIBLE STUDY** **Tuesdays, 9:30-10:30 am, room 100**

Join us as we read and discuss the Bible in our home languages and English. Everyone is welcome.

### **INTERNATIONAL FRIENDS** **Tuesdays, 10:30 am-noon, room 100**

Friendship, fun, food, and field trips! Practice casual English as you meet new friends and learn about each other while also learning about life in Indiana and other places.

### **CASUAL CONVERSATION CLASS** **Wednesdays, 4:30-6 pm, room 201**

Join the conversation and learn the most current (and old fashioned) slang. This class prepares you for real-life conversation and costs \$30.

### **ENGLISH CLASSES** **Thursdays, 9:30 am-noon** **Upstairs Classrooms**

Leveled and skill-specific English classes—Students joining us for the first time are screened to make sure they are placed in the best class for them. Classes this year include professional conversation, American accent training, written conversation, and basic conversational English. Classes cost \$60.

### **INTERNATIONAL FRIENDS FAMILY FUN** **Third Saturday of the month** **(Dec. 16, Jan. 20, Feb. 17), 2:30-4:30 pm** **Upstairs Classrooms**

By popular request, we are offering the space and the time for our Friends and their families to meet and to enjoy a hobby. Currently we have a group learning and practicing Chinese brush painting.

# OUTREACH

## DONATE BY SHOPPING

### KROGER PLUS CARD RE-REGISTRATION

CLC is using funds raised through the Kroger Community Rewards program to support food pantries in the Irvington area, just east of downtown Indianapolis. When you scan your Kroger Plus Card, a portion of your total will be given to CLC.

A new program year begins January 1 and Kroger requires ALL Kroger Plus Card participants to re-register, even if you've enrolled in the past. Go to [kroger.com/communityrewards](http://kroger.com/communityrewards) and click "Sign In" or "Create an Account". Then enroll/update your rewards in your account settings and designate "Cornerstone Lutheran".

For the first three quarters of 2017, 223 households had registered their Kroger Plus Card, resulting in nearly \$4,200 raised to support these food pantries through CLC!

### SMILE.AMAZON.COM

If you shop on this site, consider registering your amazon.com account with the AmazonSmile program and .5% of your eligible purchases will be donated to CLC. When you register, choose Cornerstone Lutheran as your charity. Then, visit/bookmark [smile.amazon.com](http://smile.amazon.com) when making purchases. Don't forget: you need to make your purchases through [smile.amazon.com](http://smile.amazon.com) for CLC to get the donation.

## DISCOVER INDY SAVINGS BOOKS

One of the ways CLC supports missionaries is through the sale of the Discover Indy Savings Book, sponsored by the Lutheran Women's Missionary League (LWML). For each of these central Indiana restaurant/entertainment coupon books sold, \$10 will go to missionary Pastor Todd Roeske. (Last year, we were able to send him \$1,000!) Books are available through December 21, either at the CLC Carmel Sanctuary Welcome Desk. Or, have your book delivered to CLC Fishers or Downtown Indy by contacting Marie Bade ([mbade5814@comcast.net](mailto:mbade5814@comcast.net), 317.570.0489).

# PRAYER

## STRATEGIC PRAYER WARRIORS

At Cornerstone Lutheran Church, we have many blessings for which we are thankful and have concerns for which we need guidance and discernment. Would you consider being a "Strategic Prayer Warrior" and for six months pray daily that the hearts of people at CLC are aligned with God's will for his church?

A Strategic Prayer Warrior:

1. Commits to daily prayer
2. Diligently prays for specific ministry needs
3. Speaks only to the Lord about the prayer requests, as confidentiality is essential

If you are committed to lifting up the ministry of Cornerstone Lutheran in daily prayer, fill out a commitment form at [www.CornerstoneLutheran.church/prayer](http://www.CornerstoneLutheran.church/prayer). Or, contact Clarissa Hay ([chay@cornerstonelutheran.church](mailto:chay@cornerstonelutheran.church), 317.814.4252 x216).

## PRAYER CHAIN

Our church has a dedicated group of disciples who lift up the coming week's altar prayers. To be placed on this email distribution list, contact Phyllis Mesenbrink ([phymesen@yahoo.com](mailto:phymesen@yahoo.com)).

## PRAYER SHAWLS

Do you knit or crochet? Consider using your talents to create prayer shawls. Volunteers make lap blankets, shawls, and scarves that are given to newborns, the hospitalized, those in cancer treatment, and others in need of a little comfort. Contact Jan Williams ([jwilliams@cornerstonelutheran.church](mailto:jwilliams@cornerstonelutheran.church), 317.814.4252 x261) with questions. Or, you can just make a prayer shawl and drop it off in the workroom.

In addition, CLC disciples are encouraged to take prayer shawls (we have many!) to give to others needing prayers. Please see the receptionist at the church office if you would like to share a prayer shawl with a friend, family member, co-worker, or neighbor who has just given birth or is going through a difficult time.

# STUDENTS

## “UKANDU” CHICAGO MISSION TRIP

**June 24-30**

**Registration open Jan. 15-Feb. 15**

We're planning a great summer trip for you! We will again be participating in the UKANDU Chicago mission trip. UKANDU is a Christian mission organization dedicated to helping youth and adults become the heart and hands of Christ to those in need around the world. The mission name comes from Philippians 4:13 – “I (YOU) can do all things through Christ who gives me strength.”

This will be our second year to serve in this mission. Visit our website at [www.CornerstoneLutheran.church/high-school](http://www.CornerstoneLutheran.church/high-school) to see a video on what UKANDU is all about. Begin prayerfully considering this wonderful mission opportunity today!

## A WARMTH BAG PROJECT

**Sunday, Dec. 17, education time**

Last year, Student Ministry started an outreach effort called “Warmth Bag Project” to support the area’s homeless. This year, students of all ages and their families at all three CLC sites will help to prepare these care packages. (See p. 10 for details.)

## F MATH TUTORING

**Sundays, 1-3 pm, CLC Fishers**

CLC disciple and high school teacher Liz Eme offers free tutoring in math at CLC Fishers. She is a certified math teacher with specialties in pre-algebra through calculus. This is an open forum. Register at [www.CornerstoneLutheran.church](http://www.CornerstoneLutheran.church) (search “math tutor”). Registration is not required, but helpful.

### STUDENT MINISTRY CONTACTS:

- **CLC Carmel High School Ministry:** Shawn Hecksel (shecksel@cornerstonelutheran.church, 317.814.4252 x220)
- **CLC Carmel 5th-8th Grade Ministry:** Bill Prann (bprann@cornerstonelutheran.church, 317.814.4252 x217).
- **CLC Fishers 5th-12th Grade Ministry:** Melissa Luepke (mluepke@cornerstonelutheran.church, 317.814.4252 x202).



# STUDENTS

## 5<sup>TH</sup>-8<sup>TH</sup>: BIBLE CLASS

- C** CLC Carmel: Sundays, 9:30-10:20 am
  - 5th-6th grade: Room 213-215
  - 7th-8th grades: Rooms 208-210
- F** CLC Fishers: Sundays, 10:15-10:55 am
  - 4th-6th grades: Classroom Q
  - 7th-8th grades: Conference Room
  - 9th-12th grades: Classroom P

## 7<sup>TH</sup>-8<sup>TH</sup>: CONFIRMATION

- C** CLC Carmel: Sundays, 5:30-7 pm, Worship Center
- F** CLC Fishers: Sundays, 12:30-2 pm, classroom N

In this two-year discipleship process, students learn what we believe as Lutherans and why we believe it. (The Rite of Confirmation is March 17.)

## **C** 5<sup>TH</sup>-6<sup>TH</sup>: FUN & FELLOWSHIP

**Dec. 3, Jan. 7, Feb. 11**  
**5:30-7 pm**

Get together for fun and fellowship with friends! We'll have fun games, a devotion, and snacks.

## H.S. BIBLE CLASS

- C** CLC Carmel: Sundays, 9:30-10:25 am Student Center
- F** CLC Fishers: Sundays, 10:15-10:55 am Classroom P

## HIGH SCHOOL GROUPS

**HIGH SCHOOL SMALL GROUPS**  
**Dec. 10, Jan. 7 & 28, Feb. 11 & 25**

Time and location according to group.

**HIGH SCHOOL LARGE GROUP NIGHT**  
**Sunday, Dec. 17, Jan. 21, Feb. 18**  
**5:30-7 pm**

Come and be re-energized in God's Word and have fun with your friends!

## **C** HIGH SCHOOL & 8<sup>TH</sup> GRADE RETREAT

**Feb. 2-3**  
**Gym & Student Center**

Let's welcome the 8th grade class into High School ministry! We'll do a variety of awesome activities, so be sure to come and experience ALL the fun at this lock-in! More information to come.

# WOMEN

## A BIBLE STUDIES

See pp. 13-16 for details.

## C ADVENT BY CANDLELIGHT

**Tuesday, December 5, 7-9 pm, Gym**

See p. 8 for details.

## LADIES NIGHT OUT

Enjoy an evening of food, fun, and girl talk! Women from all CLC sites are invited to gather with fellow disciples for a relaxing night out. Catch up with friends, reconnect with "old" ones, and meet new ones! No RSVP is necessary for these events. Simply put it on your calendar and show up! For questions or more information, contact Donnell Bradley (812.573.3658).

- **Monday, Dec. 11, 6:30-9 pm**  
Nickel Plate Bar and Grill, Fishers
- **Monday, Feb. 12, 6:30-9 pm**  
Divyv, Carmel

## C BRIDGES

**Sunday, Jan. 21, 9:30 am**  
**Room 102**

**"Blessed are the poor in spirit..."**

We will be starting a new series in 2018 focused on the Beatitudes. Join the ever-growing number of CLC women who seek to build deeper relationships with each other as they share insights of their faith journey. Bridges meets six times a year during the Sunday school hour at the Carmel site.

## BOOK CLUB

**First Tuesday of the month**  
**(Jan. 2, Feb. 6), 7-9 pm**  
**Barnes & Noble Cafe, Greyhound Pass**

Join anytime for lively book discussions! For more information, contact Debbie Salefski ([dsalefski@sbcglobal.net](mailto:dsalefski@sbcglobal.net), 317.752.6739) or Nancy Mills ([namills3@att.net](mailto:namills3@att.net), 317.430.4019).

### Book selections:

- **Jan. 2:** *Number the Stars*  
by Lois Lowery
- **Feb. 6:** *At Home in Mitford*  
by Jan Karon

# WOMEN

## MOPS: MOTHERS OF PRESCHOOLERS

**F** **MOPS @ CLC FISHERS**  
Thursdays, 9:30-11:30 am  
(Dec. 7, Jan. 18, Feb. 1 & 15)  
Contact: Sara Konopka  
(skonopka10@yahoo.com)

**C** **MOPS AT CLC CARMEL**  
Fridays, 9-11:15 am  
(Dec. 1 & 15; Jan. 12 & 26; Feb. 9 & 23)  
Contact: Micah Walton  
(mlsasse@hotmail.com)

---

MOPS (Mothers of Preschoolers) is a ministry designed to develop leadership and meet the needs of preschool mothers. Due to the popularity of this program and the huge need for childcare workers, both groups are currently full. If you would like to be placed on a wait list to become a part of this ministry, please contact the leader listed above.

### **FISHERS MOPS NEEDS:**

**Mentor Moms**—A mentor is a woman of faith who walks a few steps ahead of the women in MOPS and brings perspective on mothering, womanhood and relationships. She understands the challenges these young moms face and offers hope and encouragement. To find out more, contact Sara Konopka (info above)

### **CARMEL MOPS NEEDS:**

**Childcare**—They are in need of loving adults to care for their children while the moms meet. They are also seeking others who may be interested in working as a substitute caregiver. Pay is \$10/hour, and you can bring your child with you, if needed. For more details, contact Sarah Lawhorn (sarah.m.lawhorn@gmail.com, 317.938.1327).

# WOMEN

## IF:GATHERING 2018

**Friday, Feb. 9, 7-10 pm and  
Saturday, Feb. 10, 9 am-5 pm**

CLC Fishers will host a two-day live simulcast of the IF Gathering from Austin, Texas. At IF:Gathering we collectively come together to wrestle with essential questions of faith and encounter God in a way that allows us to be unleashed to give him away. What IF we followed God with perseverance instead of insecurity? Join us! To register or for more information, go to [www.CornerstoneLutheran.church](http://www.CornerstoneLutheran.church) and search "IF gathering".

## SPRING RETREAT

**March 3-4 (with optional Fri. night)  
Wooded Glen Retreat Center,  
Henryville, IN  
Registration opens Jan. 15**

With the theme "Deeper Still", this retreat and the beautiful setting of Wooded Glen will provide us with the time and the place to go deeper in our relationship with our heavenly Father through time alone and time with our sisters in Christ. Is God calling you to go Deeper Still?

## LWML

*The Lutheran Women's Missionary League (LWML), an auxiliary organization with the Lutheran Church-Missouri Synod, strives to develop the spiritual gifts of women through fellowship, Christian growth, and mission service.*

### LADIES DAYTIME FELLOWSHIP

**Second Friday of the month  
Dec. 8, 2 pm, gym; Jan. 12 & Feb. 9,  
12:30 - 2:30 pm, room 102**

- **Dec:** Putting cookies on trays for "Christmas Cookies, Crafts & More"
- **Jan:** Cleaning/putting away candles used on Christmas Eve
- **Feb,** Making cross necklaces for Connection Ministries

Contact Dottie Renner (317.846.0701).

### SEWING FOR MISSIONS

**Second & Fourth Wednesdays  
(Jan. 10, 24; Feb. 14, 28)  
9:15 am - 2:30 pm, room 123**

More women are needed for LWML's Sewing for Missions. This group sewed 335 quilts in 2017. Contact Barb Potts (317.846.8056).

### COLLEGE STUDENTS CARE PACKAGES

**Sunday, Feb. 4, 2018**  
*See p. 11 for details.*

### FEBRUARY SOCKS COLLECTIONS

*See p. 11 for details.*

# CLC STAFF DIRECTORY

The office phone number is 317.814.4252. Staff extensions are listed below. For an email address, call the church office, or visit [CornerstoneLutheran.church/about/staff](http://CornerstoneLutheran.church/about/staff).

<b>Senior Pastor</b> .....	Pastor Luther Brunette (x212)
<b>Pastor, Spiritual Care</b> .....	Pastor Daniel Schumm (x218)
<b>Pastor, Outreach &amp; Discipleship/Fishers Site Pastor</b> .....	Pastor Scott Giger (x213)
<b>Pastor, Contemporary Worship</b> .....	Pastor Max Murphy (x225)
<b>Pastor Emeritus</b> .....	Pastor Rollin Kuznik
<b>Pastoral Assistant</b> .....	Pastor Paul Borg
<b>Vicar/Downtown Indy Site Leader</b> .....	Victor Minetola (x222)
<b>Director of Administration</b> .....	Bruce Williams (x245)
<b>Director of Children’s Ministry</b> .....	Lisa Mohler (x215)
<b>Director of Children’s Music</b> .....	Jennifer Midkiff (x209)
<b>Director of Communications</b> .....	Mike Rowland (x223)
<b>Director of Cornerstone Lutheran Preschool</b> .....	Teresa Millwood (x219)
<b>Director of Faith Formation</b> .....	Bill Prann, DCE (x217)
<b>Director of Faith Formation, Fishers</b> .....	Melissa Luepke, DCE (x202)
<b>Director of High School &amp; Post High School Ministry, Carmel</b> .....	Shawn Hecksel, DCE (x220)
<b>Director of Multisite Ministries</b> .....	Jane Callahan (x226)
<b>Director of Play Area/Nursery Ministry, Fishers</b> .....	Tricia Statler (x228)
<b>Director of Sanctuary Music, Carmel</b> .....	Barry Bobb (x224)
<b>Director of Sanctuary Music, Fishers</b> .....	Josh Pedde (x208)
<b>Director of Women’s Ministry</b> .....	Jan Williams (x261)
<b>Director of Worship Technologies</b> .....	Eric Nelson, DCE (x268)
<b>Director of Worship Arts, Fishers</b> .....	Andrew Osborne (x229)
<b>Organist &amp; Handbell Director, Fishers</b> .....	Dan Calabrese (x227)
<b>Administrative Assistants, Carmel</b> .....	Julie Evanson & Tina Henderson (x211)
<b>Administrative Assistant, Fishers</b> .....	Ann Sobierajski (x203)
<b>Administrative Assistant to Pastors</b> .....	Jill Nisenshal (x210)
<b>Administrative Assistant, Preschool</b> .....	Cathy Graves (x221)
<b>Assistant Choir Director</b> .....	Lauren Southard (x315)
<b>Building &amp; Property Coordinator</b> .....	Gayle Carlson (x230)
<b>CLC Connect Coordinator</b> .....	Karen Minniear (x269)
<b>Communications Coordinator</b> .....	Cathy Klemm (x231)
<b>Discipleship Coordinator</b> .....	Clarissa Hay (x216)
<b>Financial Manager</b> .....	Holly Reay (x214)
<b>Graphic Designer</b> .....	Jenna Dempsey
<b>Nursery Coordinator, Carmel</b> .....	Adina Nelson



# CLC FISHERS



116TH STREET



# CLC CARMEL: 1<sup>ST</sup> FLOOR

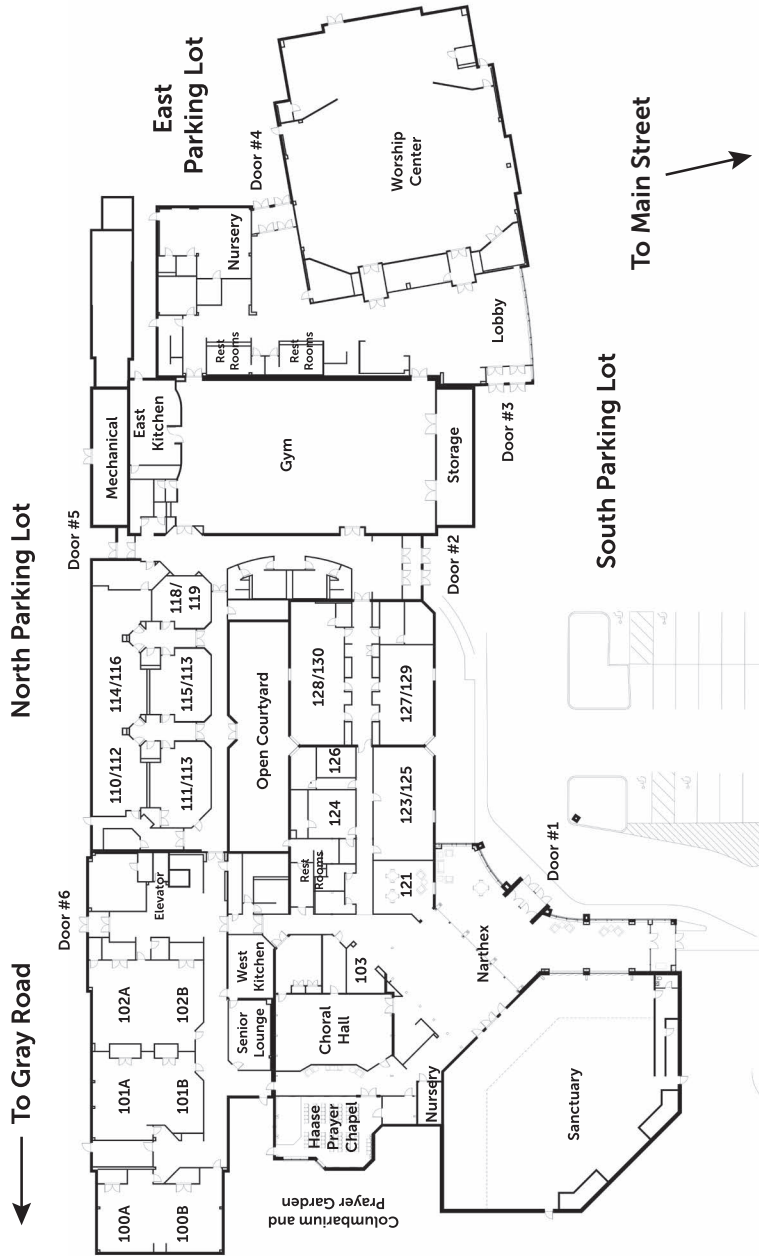

# CLC CARMEL: 2<sup>ND</sup> FLOOR

